

Boardwalk

Westminster

WHITEHALL, BRISTOL

Westminster Road WHITEHALL

APPROXIMATE FLOOR AREA
44.0 SQM / 473 SQFT



GROUND FLOOR

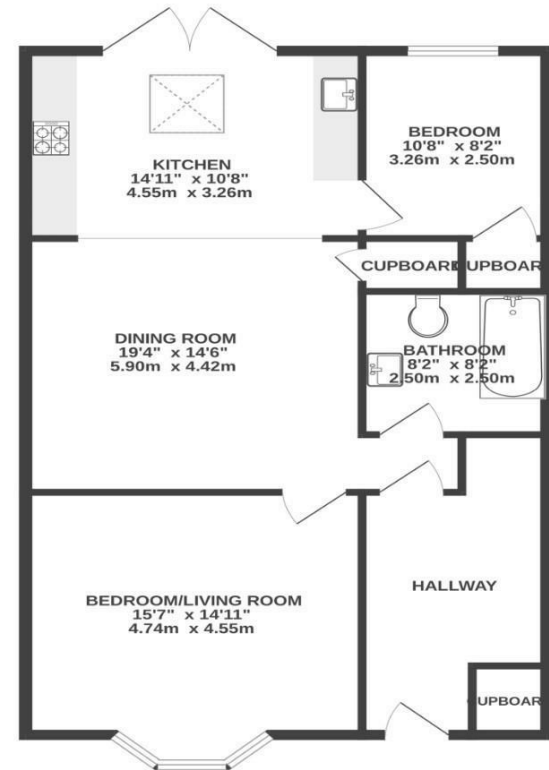

Illustrations are for reference purposes only, measurements are approximate, not to scale.

~~Boardwalk~~

Westminster

WHITEHALL, BRISTOL



£265,000



2 Bedrooms



BS5 9AN



1 Bathrooms

"We have absolutely loved our time in this flat. The south facing garden and being two minutes walk to St George's park makes for great summers. While being next to the cycle path means the city centre is quickly accessible. The amazing restaurants/cafes (recommend the lock up, crafty egg and loaf) and independent shops on church road are just a five minute walk away which always made them far too tempting!"

